

**MANDRINI PER FRESE CON ATTACCO FILETTATO**  
SCREW IN MILL CHUCKS

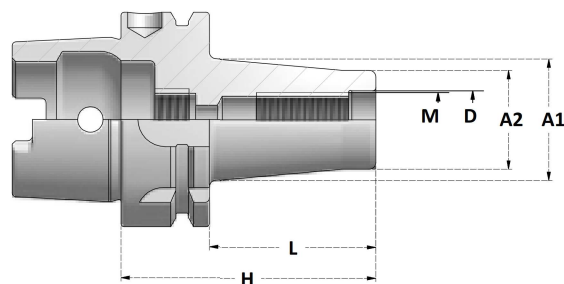

DIMENSIONI  
DELL'ATTACCO  
  
SHANK  
DIMENSIONS

G2,5 25000 r.p.m.	Articolo	M	D	H	L	A1	A2
	HSK63A.H59.M8CPY	M8	8,5	59	33	15	13
HSK63A.H84.M8CPY	M8	8,5	84	58	23	13	
HSK63A.H109.M8CPY	M8	8,5	109	83	23	13	
HSK63A.H134.M8CPY	M8	8,5	134	108	25	13	
HSK63A.H59.M10CPY	M10	10,5	59	33	20	18	
HSK63A.H84.M10CPY	M10	10,5	84	58	25	18	
HSK63A.H109.M10CPY	M10	10,5	109	83	28	18	
HSK63A.H134.M10CPY	M10	10,5	134	108	28	18	
HSK63A.H159.M10CPY	M10	10,5	159	133	34	18	
HSK63A.H59.M12CPY	M12	12,5	59	33	24	21	
HSK63A.H84.M12CPY	M12	12,5	84	58	24	21	
HSK63A.H109.M12CPY	M12	12,5	109	83	31	21	
HSK63A.H134.M12CPY	M12	12,5	134	108	31	21	
HSK63A.H159.M12CPY	M12	12,5	159	133	38	21	
HSK63A.H184.M12CPY	M12	12,5	184	158	42	21	
HSK63A.H59.M16CPY	M16	17	59	33	34	29	
HSK63A.H84.M16CPY	M16	17	84	58	34	29	
HSK63A.H109.M16CPY	M16	17	109	83	34	29	
HSK63A.H134.M16CPY	M16	17	134	108	39	29	
HSK63A.H159.M16CPY	M16	17	159	133	39	29	
HSK63A.H184.M16CPY	M16	17	184	158	39	29	

Momento di serraggio consigliato  
Recommended tightening torque

<b>M8</b>	25Nm
<b>M10</b>	40Nm
<b>M12</b>	60Nm
<b>M16</b>	80Nm

G2,5 15000 r.p.m.	Articolo	M	D	H	L	A1	A2
	HSK100A.H87.M12CPY	M12	12,5	87	58	32	21
HSK100A.H137.M12CPY	M12	12,5	137	108	32	21	
HSK100A.H187.M12CPY	M12	12,5	187	158	36	21	
HSK100A.H87.M16CPY	M16	17	87	58	36	29	
HSK100A.H137.M16CPY	M16	17	137	108	40	29	
HSK100A.H187.M16CPY	M16	17	187	158	42	29	
HSK100A.H237.M16CPY	M16	17	237	208	48	29	

ACCESSORI - ACCESSORIES



**MANDRINI PER FRESE CON ATTACCO FILETTATO**  
SCREW IN MILL CHUCKS

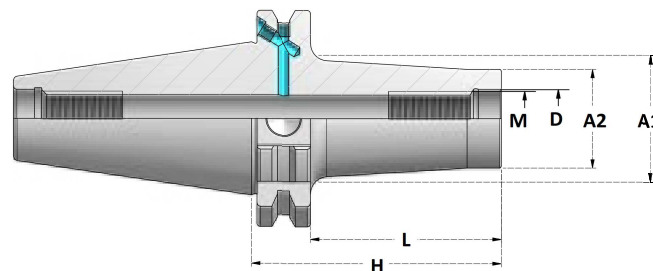

DIMENSIONI  
DELL'ATTACCO

SHANK  
DIMENSIONS



Articolo	M	D	H	L	A1	A2
TCB40.H55.M8CPY	M8	8,5	55	35	15	13
TCB40.H75.M8CPY	M8	8,5	75	55	23	13
TCB40.H95.M8CPY	M8	8,5	95	75	23	13
TCB40.H115.M8CPY	M8	8,5	115	95	25	13
TCB40.H55.M10CPY	M10	10,5	55	35	20	18
TCB40.H75.M10CPY	M10	10,5	75	55	25	18
TCB40.H95.M10CPY	M10	10,5	95	75	28	18
TCB40.H115.M10CPY	M10	10,5	115	95	28	18
TCB40.H145.M10CPY	M10	10,5	145	125	34	18
TCB40.H55.M12CPY	M12	12,5	55	35	24	21
TCB40.H75.M12CPY	M12	12,5	75	55	24	21
TCB40.H95.M12CPY	M12	12,5	95	75	31	21
TCB40.H115.M12CPY	M12	12,5	115	95	31	21
TCB40.H145.M12CPY	M12	12,5	145	125	38	21
TCB40.H175.M12CPY	M12	12,5	175	155	42	21
TCB40.H55.M16CPY	M16	17	55	35	34	29
TCB40.H75.M16CPY	M16	17	75	55	34	29
TCB40.H95.M16CPY	M16	17	95	75	34	29
TCB40.H115.M16CPY	M16	17	115	95	39	29
TCB40.H145.M16CPY	M16	17	145	125	39	29
TCB40.H175.M16CPY	M16	17	175	155	39	29

Momento di serraggio consigliato  
Recommended tightening torque

<b>M8</b>	25Nm
<b>M10</b>	40Nm
<b>M12</b>	60Nm
<b>M16</b>	80Nm



Articolo	M	D	H	L	A1	A2
TCB50.H85.M10CPY	M10	10,5	85	65	28	18
TCB50.H135.M10CPY	M10	10,5	135	115	28	18
TCB50.H185.M10CPY	M10	10,5	185	165	32	18
TCB50.H85.M12CPY	M12	12,5	85	65	32	21
TCB50.H135.M12CPY	M12	12,5	135	115	32	21
TCB50.H185.M12CPY	M12	12,5	185	165	36	21
TCB50.H85.M16CPY	M16	17	85	65	36	29
TCB50.H135.M16CPY	M16	17	135	115	40	29
TCB50.H185.M16CPY	M16	17	185	165	42	29

ACCESSORI - ACCESSORIES

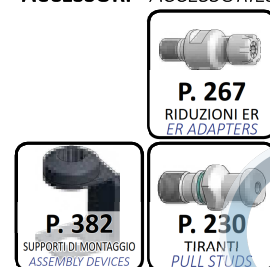

MAS 403 (JIS B 6339)

BT

CPY

**MANDRINI PER FRESE CON ATTACCO FILETTATO**  
SCREW IN MILL CHUCKS

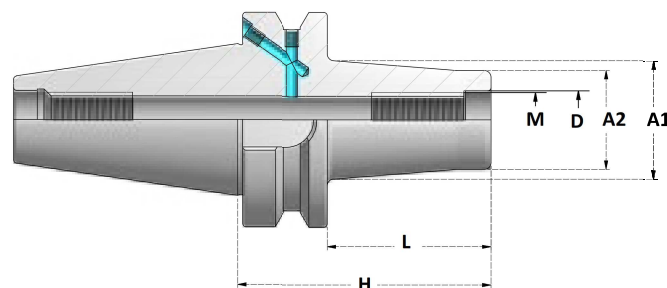

DIMENSIONI  
DELL'ATTACCO

SHANK  
DIMENSIONS



Articolo	M	D	H	L	A1	A2
BTB40.H63.M8CPY	M8	8,5	63	36	15	13
BTB40.H83.M8CPY	M8	8,5	83	56	23	13
BTB40.H103.M8CPY	M8	8,5	103	76	23	13
BTB40.H123.M8CPY	M8	8,5	123	96	25	13
BTB40.H63.M10CPY	M10	10,5	63	36	20	18
BTB40.H83.M10CPY	M10	10,5	83	56	25	18
BTB40.H103.M10CPY	M10	10,5	103	76	28	18
BTB40.H123.M10CPY	M10	10,5	123	96	28	18
BTB40.H153.M10CPY	M10	10,5	153	126	34	18
BTB40.H63.M12CPY	M12	12,5	63	36	24	21
BTB40.H83.M12CPY	M12	12,5	83	56	24	21
BTB40.H103.M12CPY	M12	12,5	103	76	31	21
BTB40.H123.M12CPY	M12	12,5	123	96	31	21
BTB40.H153.M12CPY	M12	12,5	153	126	38	21
BTB40.H183.M12CPY	M12	12,5	183	156	42	21
BTB40.H63.M16CPY	M16	17	63	36	34	29
BTB40.H83.M16CPY	M16	17	83	56	34	29
BTB40.H103.M16CPY	M16	17	103	76	34	29
BTB40.H123.M16CPY	M16	17	123	96	39	29
BTB40.H153.M16CPY	M16	17	153	126	39	29
BTB40.H183.M16CPY	M16	17	183	156	39	29

Momento di serraggio consigliato  
Recommended tightening torque

<b>M8</b>	25Nm
<b>M10</b>	40Nm
<b>M12</b>	60Nm
<b>M16</b>	80Nm



Articolo	M	D	H	L	A1	A2
BTB50.H104.M10CPY	M10	10,5	104	66	28	18
BTB50.H154.M10CPY	M10	10,5	154	116	28	18
BTB50.H104.M12CPY	M12	12,5	104	66	32	21
BTB50.H154.M12CPY	M12	12,5	154	116	32	21
BTB50.H104.M16CPY	M16	17	104	66	36	29
BTB50.H154.M16CPY	M16	17	154	116	40	29

ACCESSORI - ACCESSORIES

