

## PE ADATTATORI PER PINZE ELASTICHE

Pinze elastiche e chiavi di serraggio escluse

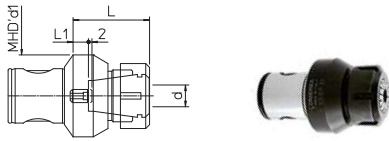

REF.	CODE	MHD' d1	d	L	L1	kg			N·m
PE 20 / ER16M	655702000160	20	0,5-10	32	1	0,06	ER-16M	E16M	40
PE 32 / ER25M	655703200250	32	1-16	42	1,5	0,25	ER-25M	E25M	160
PE 40 / ER25	655704000250	40	1-16	45	5	0,4	UM/ER25	E25	200
PE 50 / ER25	655705000250	50	1-16	48	7	0,7	UM/ER25	E25	200
PE 50 / ER32	655705000320	50	2-20	55	8	1	UM/ER32	E32	220
PE 63 / ER32	655706300320	63	2-20	59	12	1,3	UM/ER32	E32	220

## FORCE ADATTATORI A FORTE SERRAGGIO

**new**

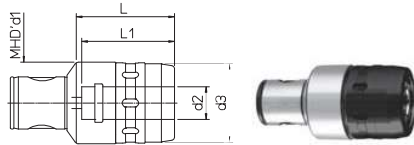

Pinze elastiche e chiavi di serraggio escluse

REF.	CODE	MHD' d1	d2	d3	L	L1	kg
FORCE 50/20	656305000200	50	20	48	60	60	1
FORCE 63/32	656306300320	63	32	66	80	80	2

## AW ADATTATORI WELDON WHISTLE NOTCH

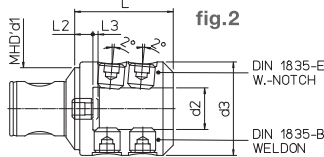
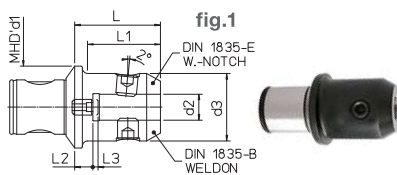

REF.	CODE	MHD' d1	d2 <sup>H5</sup>	d3	L	L1	L2	L3	kg	fig.
AW 50/6	655805000060	50	6	25	44	32,5	7	2	0,5	1
AW 50/8	655805000080	50	8	28	44	33	7	2	0,5	1
AW 50/10	655805000100	50	10	35	52	42	11	3	0,7	1
AW 50/12	655805000120	50	12	42	57	48	11	3	0,8	1
AW 50/14	655805000140	50	14	42	57	48	11	3	0,8	1
AW 50/16	655805000160	50	16	48	67	61	17	4	1,1	1
AW 50/20	655805000200	50	20	51	67	16	4	1,2	1	1
AW 50/25	655805000250	50	25	63	80	22	4	1,8	2	2
AW 63/16	655806300160	63	16	48	64	53	14	4	1,4	1
AW 63/20	655806300200	63	20	52	66	56	14	4	1,5	1
AW 63/25	655806300250	63	25	64	74	16	4	2,1	2	2
AW 63/32	655806300320	63	32	72	76	14	4	2,5	2	2
AW 80/40	655808000400	80	40	80	83	12	4	3,2	2	2

## PF ADATTATORI PER FRESE A DISCO E A SPIANARE

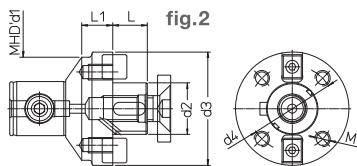
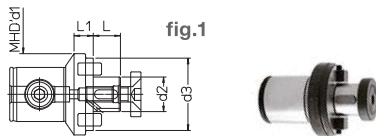

REF.	CODE	MHD' d1	d2	d3	d4	M	L	L1	kg	fig.
PF 40/16	655904020165	40	16	32			17	15	0,3	1
PF 40/22	655904020225	40	22	40			19	13	0,4	1
PF 50/16	655905000160	50	16	32			17	15	0,5	1
PF 50/22	655905000220	50	22	40			19	15	0,5	1
PF 50/27	655905000270	50	27	50			21	15	0,6	1
PF 50/32	655905000320	50	32	60			24	15	0,7	1
PF 63/22	655906300220	63	22	60			19	15	0,9	1
PF 63/27	655906300270	63	27	60			21	15	1,1	1
PF 63/32	655906300320	63	32	63			24	15	1,2	1
PF 80/32	655908000320	80	32	80			24	24	1,7	1
PF 80/40	655908000400	80	40	84	66,7	M12	27	24	1,9	2
PF 80/50	655908000500	80	50	90			30	24	2,0	2
PF 80/60	655908000600	80	60	128,5	101,6	M16	40	31,5	3,5	2

## MHD' 80 - HT 8 ADATTATORE MHD' 80 - HT 8

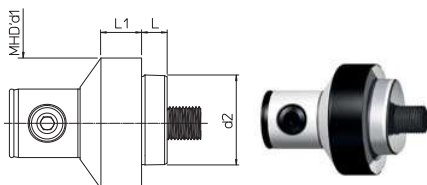

**new**

REF.	CODE	MHD' d1	d2	L	L1	kg
MHD'80-HT8	655108000080	80	HT8	15,5	25	2

## NS ADATTATORI SEMILAVORATI

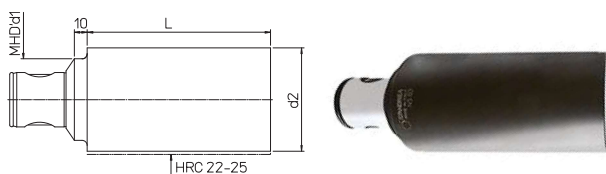

SPECIALI A RICHIESTA

REF.	CODE	MHD' d1	d2	L	kg
NS 50	657205001600	50	63	160	4,2
NS 63	657206302000	63	80	200	8,7
NS 80	657208002500	80	100	250	16