

- CHUCKING TOOLS
- ADAPTER
- ADAPTADORES
- ADAPTATEURS
- ADATTATORI

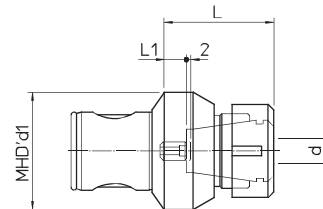

- COLLETS CHUCKING TOOLS
- SPANNZANGENFUTTER
- ADAPTADORES PARA PINZAS ELÁSTICAS
- ADAPTATEURS POUR PINCES DE SERRAGE
- ADATTATORI PER PINZE ELASTICHE

ER DIN 6499

PE



- Supplied without collets and clamping wrenches
- Ohne Spannzangen und Spannschlüssel.
- Pinzas elásticas y llaves de apriete excluidas
- Sans pinces et clés de serrage
- Pinze elastiche e chiavi di serraggio escluse

| REF.          | CODE         | MHD' d1 | d        | L  | L1  | kg   |  |  | N·m |
|---------------|--------------|---------|----------|----|-----|------|---|---|-----|
| PE 16 / ER11M | 655701600110 | 16      | 0.5 ~ 7  | 25 | 2.5 | 0.03 | ER-11M  | E11M  | 30  |
| PE 20 / ER16M | 655702000160 | 20      | 0.5 ~ 10 | 32 | 1   | 0.06 | ER-16M  | E16M  | 40  |
| PE 25 / ER20M | 655702500200 | 25      | 1 ~ 13   | 40 | 2.5 | 0.15 | ER-20M  | E20M  | 80  |
| PE 32 / ER25M | 655703200250 | 32      | 1 ~ 16   | 42 | 1.5 | 0.25 | ER-25M  | E25M  | 160 |
| PE 40 / ER25  | 655704000250 | 40      |          | 45 | 5   | 0.4  | UM/ER25   | E25   | 200 |
| PE 50 / ER25  | 655705000250 | 50      |          | 48 | 7   | 0.7  |   |   |     |
| PE 50 / ER32  | 655705000320 | 63      | 2 ~ 20   | 55 | 8   | 1    | UM/ER32   | E32   | 220 |
| PE 63 / ER32  | 655706300320 |         |          | 59 | 12  | 1.3  |   |   |     |
| PE 63 / ER40  | 655706300400 |         | 3 ~ 26   | 64 |     | 1.5  | UM/ER40   | E40   | 250 |

- ULTRA-TIGHT TOOLHOLDER FORCE
- FORCE SPANNZANGENFUTTER MIT HOCHFESTER WERKZEUGSPANNUNG
- ADAPTADORES DE GRAN APRIETE FORCE
- ADAPTATEURS À SERRAGE FORT FORCE
- ADATTATORI A FORTE SERRAGGIO FORCE

MHD' FORCE

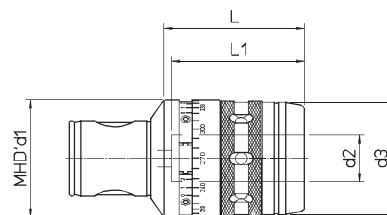

- Supplied without collets and clamping wrenches
- Ohne Spannzangen und Spannschlüssel.
- Pinzas elásticas y llaves de apriete excluidas
- Sans pinces et clés de serrage
- Pinze elastiche e chiavi di serraggio escluse

| REF.           | CODE         | MHD' d1 | d2 | d3 | L  | L1 | kg |
|----------------|--------------|---------|----|----|----|----|----|
| FORCE 50/20 HS | 656305000205 | 50      | 20 | 48 | 60 | 60 | 1  |
| FORCE 63/32 HS | 656306300325 | 63      | 32 | 66 | 80 | 80 | 2  |

120-136

241-242

222

222

