

TRC 14
Ø 14.5 ~ 18

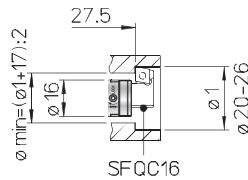

TRC 16
Ø 18 ~ 24

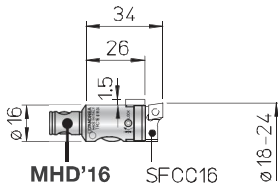
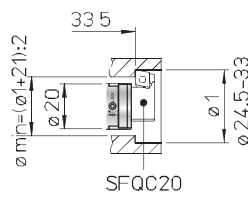
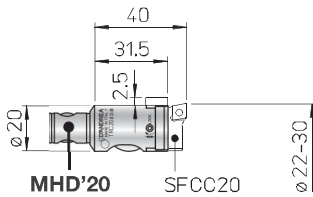

TRC 20
Ø 22 ~ 30

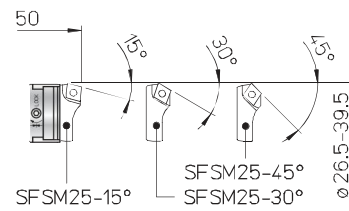
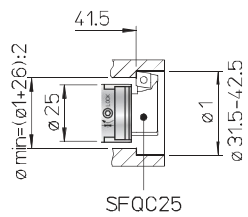
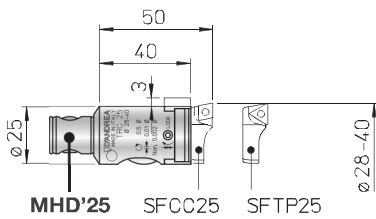

TRC 25
Ø 28 ~ 40

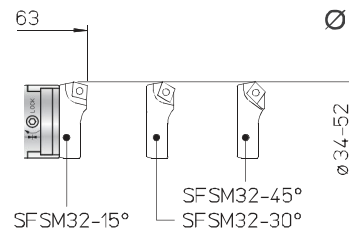
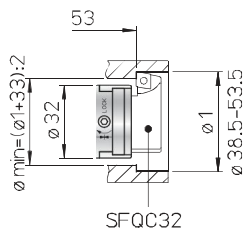
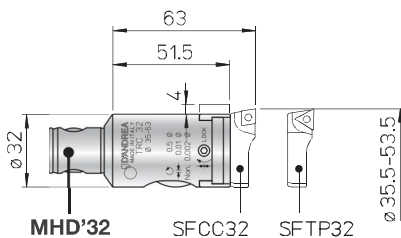

TRC 32
Ø 35.5 ~ 53.5

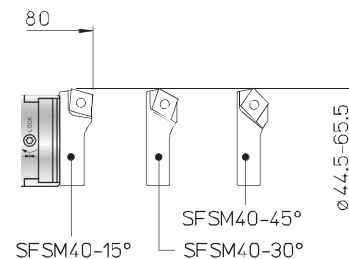
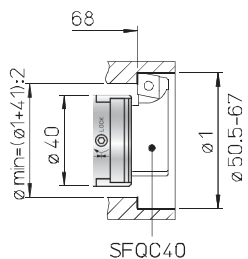
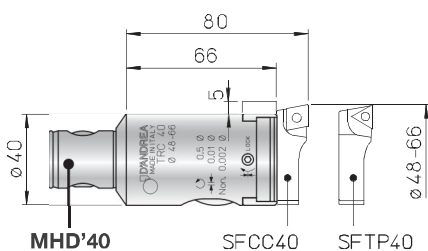

TRC 40
Ø 48 ~ 66



• TESTAROSSA

TRC



10 μm
nonio
vernier 2 μm

REF.	CODE	Kg.
TRC 14	455011400301	0.02
TRC 16	455011600341	0.05
TRC 20	455012000401	0.1
TRC 25	455012500501	0.2
TRC 32	455013200631	0.35
TRC 40	455014000801	0.7

- BIT-HOLDERS FOR TESTAROSSA
- PLATTENHALTER FÜR TESTAROSSA
- PORTA-PLAQUITAS PARA TESTAROSSA
- PORTE-PLAQUETTES POUR TESTAROSSA
- SEGGI PER TESTAROSSA

SF

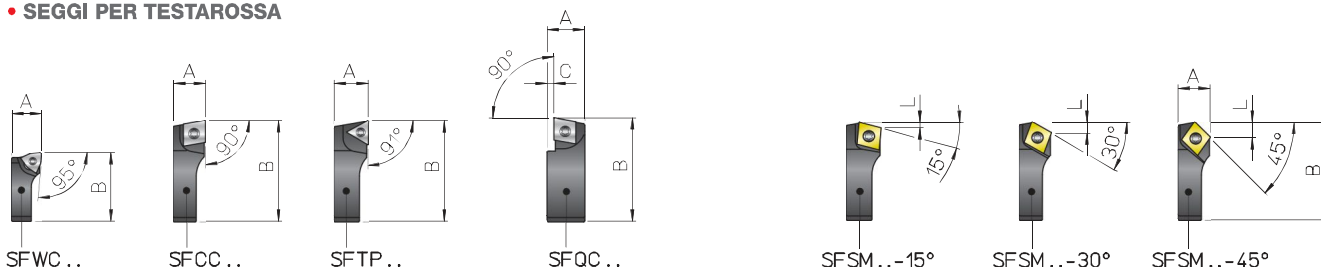

REF.	CODE	A	B	C	L	⊖	⊖	⊖	⊖	⊖	Kg.
SFWC 14	470500514002	8	14	-	-	WCGT 0201..	-	-	TS 211	TORX T06	0.003
SFCC 16	470500516002	8	17	-	-	-	-	-	-	-	0.003
SFCC 20	470500520002	8.5	21	-	-	-	CCGT 0602..	-	TS 25	TORX T08	0.005
SFCC 25	470500525002	10	26.5	-	-	-	-	-	-	-	0.01
SFCC 32	470500532002	11.5	34.5	-	-	-	-	-	-	-	0.02
SFCC 40	470500540002	14	44	-	-	-	CCGT 09T3..	-	TS 4	TORX T15	0.04
SFTP 25	470500525001	10	26.5	-	-	-	-	TPGX 0902..	CS 250T	TORX T08	0.01
SFTP 32	470500532001	11.5	34.5	-	-	-	-	-	-	-	0.02
SFTP 40	470500540001	14	44	-	-	-	-	TPGX 1103..	CS 300890T	-	0.04
SFQC 16	470500516062	10	18	2	-	-	-	-	-	-	0.005
SFQC 20	470500520062	10.5	22.5	2	-	-	-	-	-	-	0.008
SFQC 25	470500525062	12	28.5	2.5	-	-	CCMT 0602..	-	TS 25	TORX T08	0.01
SFQC 32	470500532062	13.5	35.5	2.5	-	-	-	-	-	-	0.03
SFQC 40	470500540062	16.5	46	3	-	-	CCMT 09T3..	-	TS 4	TORXT15	0.06
SFSM 25-15°	470500525011	10	25.5	-	1.6	-	-	-	-	-	0.01
SFSM 25-30°	470500525013	10	25.5	-	3	-	-	-	-	-	0.01
SFSM 25-45°	470500525015	10	25.5	-	4.3	-	-	-	-	-	0.01
SFSM 32-15°	470500532011	11.5	33.5	-	1.6	-	CCMT 0602..	-	TS 25	TORX T08	0.02
SFSM 32-30°	470500532013	11.5	33.5	-	3	-	-	-	-	-	0.02
SFSM 32-45°	470500532015	11.5	33.5	-	4.3	-	-	-	-	-	0.02
SFSM 40-15°	470500540011	14	42.5	-	2.4	-	-	-	-	-	0.03
SFSM 40-30°	470500540013	14	42.5	-	4.6	-	CCMT 09T3..	-	TS 4	TORXT15	0.03
SFSM 40-45°	470500540015	14	42.5	-	6.5	-	-	-	-	-	0.03