

CHIAVI PER GHIERE DI SERRAGGIO WRENCHES FOR CLAMPING NUTS

CHIAVI PER GHIERE CON TACCHE

WRENCHES FOR NUTS WITH SLOTS

| Articolo | A | Per / For |
|--------------|----|-----------------------------|
| CH8M | 12 | G8M |
| CH11M | 16 | G11M- G11ML |
| CH16M | 22 | G16M- G16WDM- G16ML- G16HTM |
| CH20M | 28 | G20M- G20WDM- G20ML- G20HTM |
| CH25M | 35 | G25M- G25WDM- G25ML- G25HTM |



| Articolo | A | Per / For |
|--------------|----|---|
| CH16S | 32 | G16S- G16WD- G16C- G16SL- G16WDL- G16ETS |
| CH20S | 35 | G20S- G20WD- G20C- G20SL- G20WDL- G20ETS |
| CH25S | 42 | G25S- G25WD- G25C- G25SL- G25WDL- G25HT- G25ETS |
| CH32S | 50 | G32S- G32WD- G32C- G32SL- G32WDL- G32HT- G32CLS- G32THS- G32ETS |
| CH40S | 63 | G40S- G40WD- G40C- G40SL- G40WDL- G40HT- G40ETS |
| CH50S | 78 | G50S |

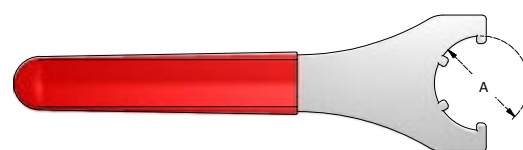

CHIAVI A FORCHETTA PER GHIERE ESAGONALI (CON PIANI)

WRENCHES WITH OPEN-END FOR HEXAGON NUTS (WITH FLATS)

| Articolo | E | Per / For |
|---------------|----|-------------------------------|
| CH.E14 | 14 | G11MSE |
| CH.E15 | 15 | G11A.EX |
| CH.E17 | 17 | G11E- G11SEL |
| CH.E19 | 19 | G16A.EX |
| CH.E22 | 22 | G16MSE- G20A.EX- G16ETSM |
| CH.E25 | 25 | G16SE- G16WDE- G16SEL- G16HTE |
| CH.E27 | 27 | G20MSE- G25A.EX |
| CH.E28 | 28 | G20ETSM |
| CH.E30 | 30 | G20SE- G20WDE- G20SEL- G20HTE |
| CH.E32 | 32 | G32A.EX |
| CH.E34 | 34 | G25MSE- G25ETSM |
| CH.E36 | 36 | |
| CH.E38 | 38 | G25SE |
| CH.E42 | 42 | G42A.EX |
| CH.E50 | 50 | |



CHIAVI CON PERNI PER GHIERE "A" CON FORI

PIN-WRENCHES FOR "A" NUTS WITH HOLES

| Articolo | I | Per / For |
|--------------|-------|-----------|
| CH11A | 13,35 | G11A |
| CH16A | 17,5 | G16A |
| CH20A | 20,6 | G20A |
| CH25A | 23,75 | G25A |
| CH32A | 31 | G32A |

