

MANDRINI DI RIDUZIONE CONO MORSE PER PUNTE

MORSE TAPER ADAPTERS FOR DRILLS

Fig.1

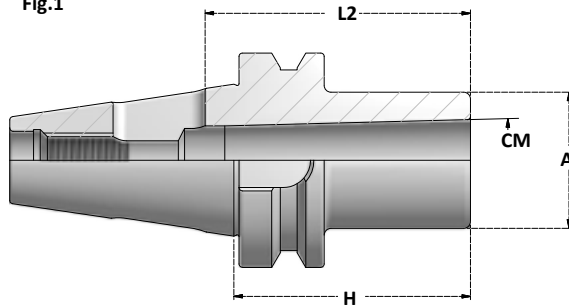
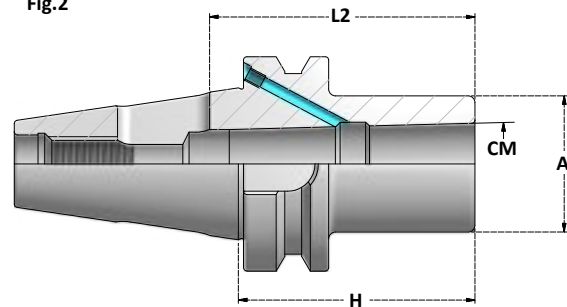

Fig.2



SCHEDA TECNICA
TECHNICAL DATA
P. 418
RIDUZIONI CM PUNTE
ADAPTERS FOR DRILLS

DIMENSIONI
DELL'ATTACCO
SHANK
DIMENSIONS

G6,3	15000 r.p.m.	Articolo	CM	H	A	L2	Fig
	AD	BT30.H50.CM1P	CM1	50	25	56	1
		BT30.H60.CM2P	CM2	60	32	67	1
		BT30.H79.CM3P	CM3	79	40	84	1

G6,3	15000 r.p.m.	Articolo	CM	H	A	L2	Fig
	AD	BT40.H50.CM1P	CM1	50	25	56	1
		BT40.H120.CM1P	CM1	120	25	56	3
		BT40.H50.CM2P	CM2	50	32	67	1
		BT40.H120.CM2P	CM2	120	32	67	3
		BT40.H70.CM3P	CM3	70	40	84	1
		BT40.H135.CM3P	CM3	135	40	84	3
		BT40.H95.CM4P	CM4	95	48	107	1
		BT40.H165.CM4P	CM4	165	48	107	3

PER UTENSILI DIN228B
CON TENONE
FOR TOOLS DIN228B
WITH TANG

Fig.3

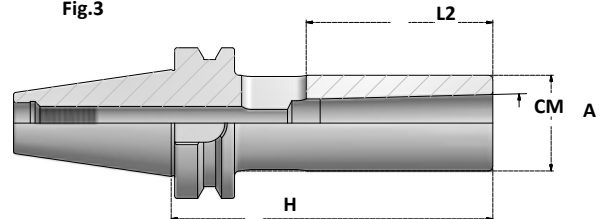

G6,3	15000 r.p.m.	Articolo	CM	H	A	L2	Fig
	AD	BT50.H45.CM1P	CM1	45	25	56	1
		BT50.H120.CM1P	CM1	120	25	56	3
		BT50.H60.CM2P	CM2	60	32	67	1
		BT50.H135.CM2P	CM2	135	32	67	3
		BT50.H65.CM3P	CM3	65	40	84	1
		BT50.H155.CM3P	CM3	155	40	84	3
		BT50.H95.CM4P	CM4	95	48	107	1
		BT50.H180.CM4P	CM4	180	48	107	3
		BT50.H105.CM5P	CM5	105	63	135	1
		BT50.H215.CM5P	CM5	215	63	135	3

G6,3	15000 r.p.m.	Articolo	CM	H	A	L2	Fig
	AD+B	BTB40.H50.CM2P	CM2	50	32	67	2
		BTB40.H70.CM3P	CM3	70	40	84	2
		BTB40.H95.CM4P	CM4	95	48	107	2

G6,3	15000 r.p.m.	Articolo	CM	H	A	L2	Fig
	AD+B	BTB50.H60.CM2P	CM2	60	32	67	2
		BTB50.H65.CM3P	CM3	65	40	84	2
		BTB50.H95.CM4P	CM4	95	48	107	2
		BTB50.H105.CM5P	CM5	105	63	135	2

ACCESSORI - ACCESSORIES

