

MANDRINI PORTAFRESA FISSI
SHELL MILL HOLDERS

DIMENSIONI
DELL'ATTACCO

SHANK
DIMENSIONS

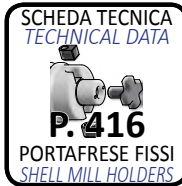
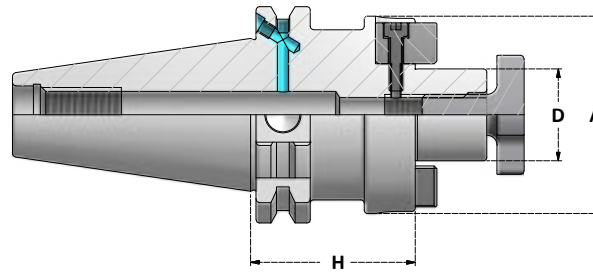

| G6,3 15000 r.p.m. AD | Articolo | D | H | A | TTR | VTC |
|----------------------------|-----------------|----|----|---------|---------|---------|
| | * TC30.H35.D16S | 16 | 35 | 38 | TTR.D16 | VTC.D16 |
| * TC30.H35.D22S | 22 | 35 | 40 | TTR.D22 | VTC.D22 | |
| * TC30.H60.D27S | 27 | 60 | 58 | TTR.D27 | VTC.D27 | |
| * TC30.H60.D32S | 32 | 60 | 78 | TTR.D32 | VTC.D32 | |

* SENZA CANALI PER IL REFRIGERANTE
WITHOUT COOLANT CHANNELS

| G6,3 15000 r.p.m. AD+B | Articolo | D | H | A | TTR | VTC |
|------------------------------|----------------|-----|----|---------|---------|---------|
| | TCB40.H35.D16S | 16 | 35 | 38 | TTR.D16 | VTC.D16 |
| TCB40.H45.D16S | 16 | 45 | 38 | TTR.D16 | VTC.D16 | |
| TCB40.H100.D16S | 16 | 100 | 38 | TTR.D16 | VTC.D16 | |
| TCB40.H130.D16S | 16 | 130 | 38 | TTR.D16 | VTC.D16 | |
| TCB40.H160.D16S | 16 | 160 | 38 | TTR.D16 | VTC.D16 | |
| TCB40.H200.D16S | 16 | 200 | 38 | TTR.D16 | VTC.D16 | |
| TCB40.H35.D22S | 22 | 35 | 48 | TTR.D22 | VTC.D22 | |
| TCB40.H45.D22S | 22 | 45 | 48 | TTR.D22 | VTC.D22 | |
| TCB40.H100.D22S | 22 | 100 | 48 | TTR.D22 | VTC.D22 | |
| TCB40.H130.D22S | 22 | 130 | 48 | TTR.D22 | VTC.D22 | |
| TCB40.H160.D22S | 22 | 160 | 48 | TTR.D22 | VTC.D22 | |
| TCB40.H200.D22S | 22 | 200 | 48 | TTR.D22 | VTC.D22 | |
| TCB40.H35.D27S | 27 | 35 | 50 | TTR.D27 | VTC.D27 | |
| TCB40.H50.D27S | 27 | 50 | 58 | TTR.D27 | VTC.D27 | |
| TCB40.H100.D27S | 27 | 100 | 58 | TTR.D27 | VTC.D27 | |
| TCB40.H130.D27S | 27 | 130 | 58 | TTR.D27 | VTC.D27 | |
| TCB40.H160.D27S | 27 | 160 | 58 | TTR.D27 | VTC.D27 | |
| TCB40.H200.D27S | 27 | 200 | 58 | TTR.D27 | VTC.D27 | |
| TCB40.H50.D32S | 32 | 50 | 78 | TTR.D32 | VTC.D32 | |
| TCB40.H55.D32S | 32 | 55 | 78 | TTR.D32 | VTC.D32 | |
| TCB40.H100.D32S | 32 | 100 | 78 | TTR.D32 | VTC.D32 | |
| TCB40.H130.D32S | 32 | 130 | 78 | TTR.D32 | VTC.D32 | |
| TCB40.H160.D32S | 32 | 160 | 78 | TTR.D32 | VTC.D32 | |
| TCB40.H200.D32S | 32 | 200 | 78 | TTR.D32 | VTC.D32 | |
| TCB40.H60.D40S | 40 | 60 | 88 | TTR.D40 | VTC.D40 | |
| TCB40.H100.D40S | 40 | 100 | 88 | TTR.D40 | VTC.D40 | |
| TCB40.H130.D40S | 40 | 130 | 88 | TTR.D40 | VTC.D40 | |
| TCB40.H160.D40S | 40 | 160 | 88 | TTR.D40 | VTC.D40 | |
| TCB40.H200.D40S | 40 | 200 | 88 | TTR.D40 | VTC.D40 | |

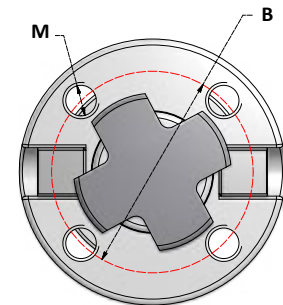

MANDRINI PER FRESE A SPIANARE CON 4 FORI
FACE MILL HOLDERS WITH 4 HOLES

| G6,3 15000 r.p.m. AD+B | Articolo | D | H | A | B | M | TTR | VTC |
|------------------------------|-----------------|----|----|----|------|-----|---------|---------|
| | TCB40.H60.D40FM | 40 | 60 | 88 | 66,7 | M12 | TTR.D40 | VTC.D40 |

ACCESSORI - ACCESSORIES

